

**BORSI PICKUPS INSTALLATION
FOR YAMAHA SLG200S**



Take out the screws



Take out the screws



BORSI
PICKUPS



Remove the bottom frame



Take out the screws





Take out the pickguard

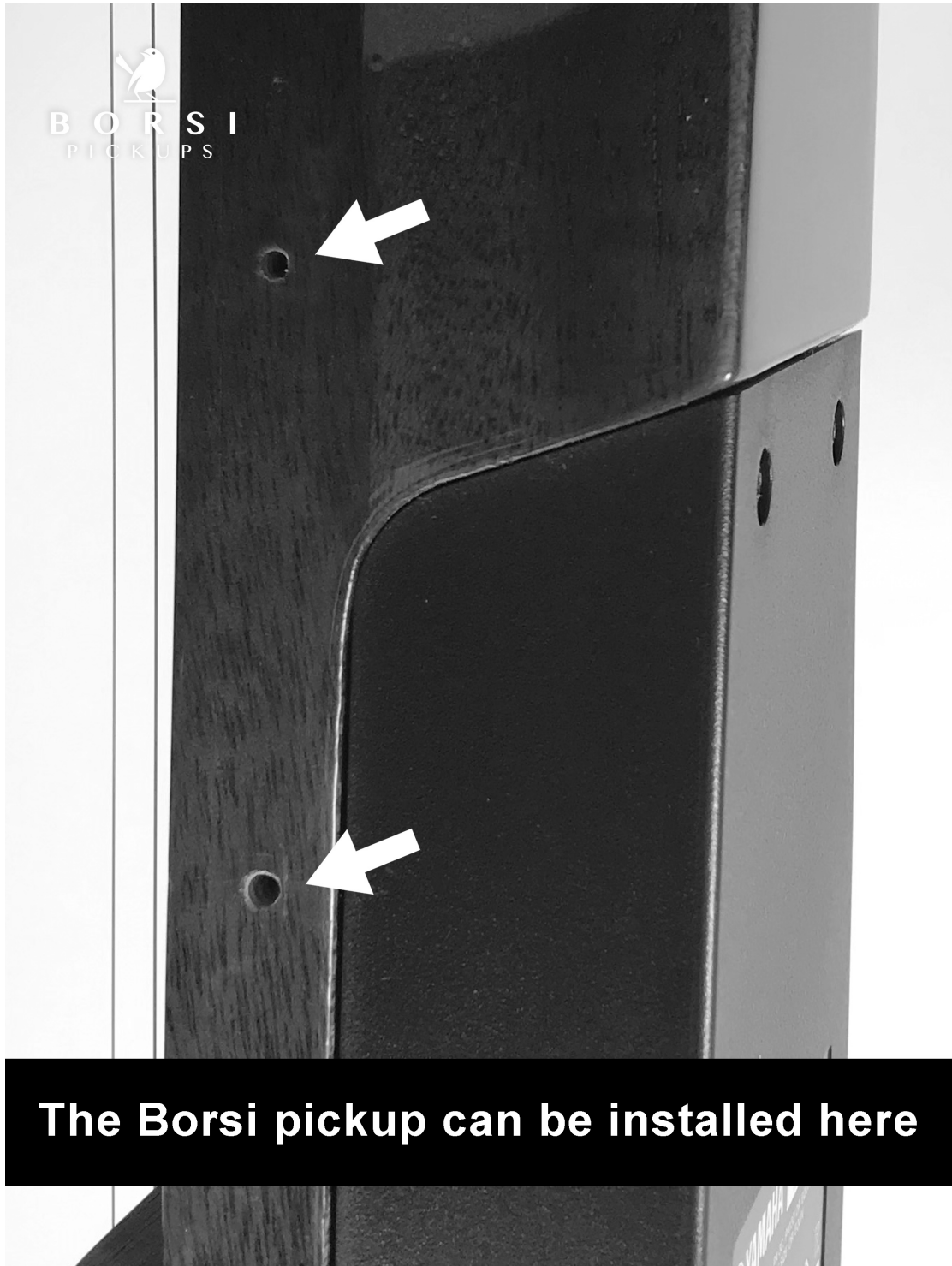

The Borsi pickup can be installed here



BORSI
PICKUPS

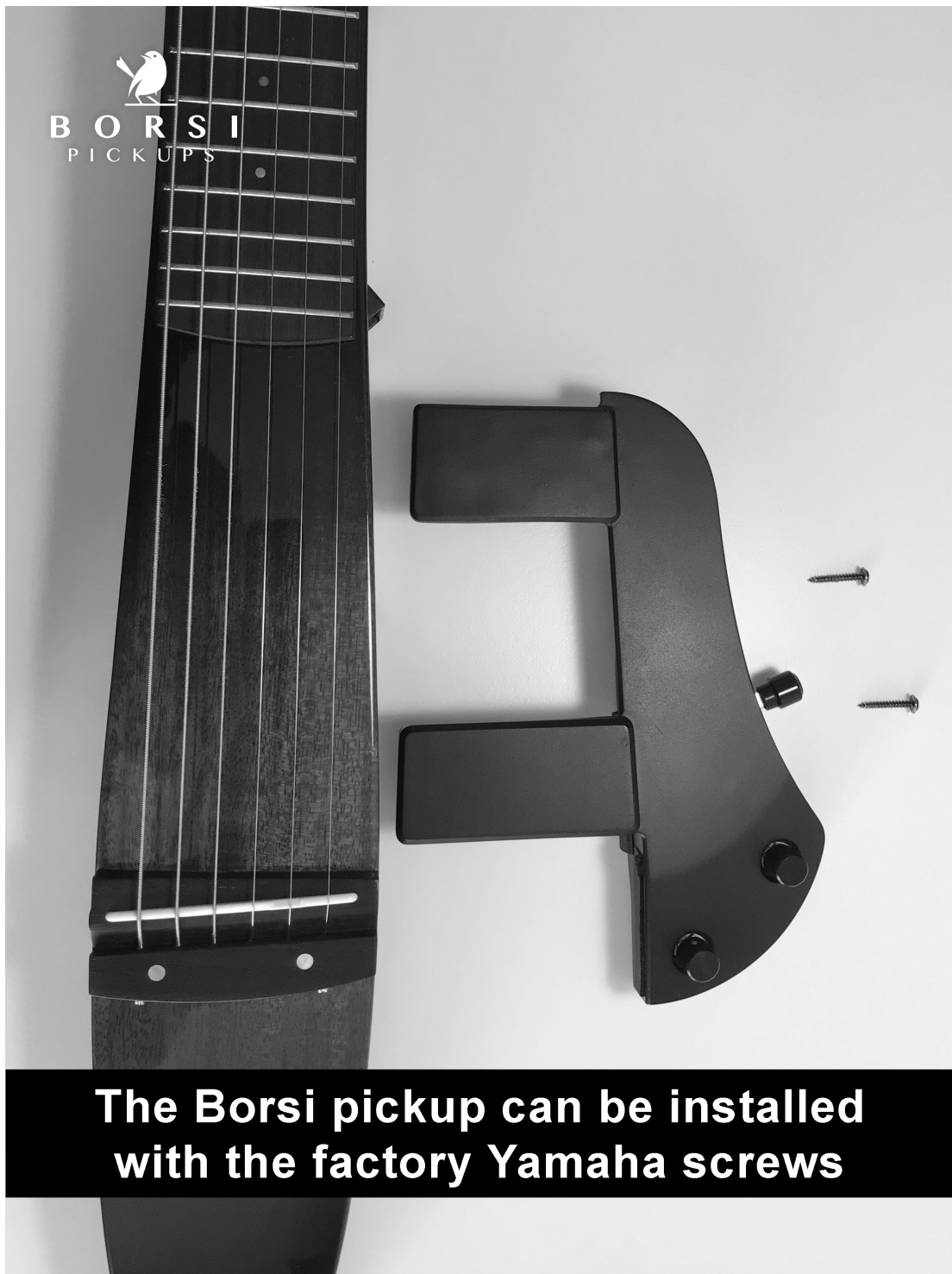

**The Borsi pickup can be installed
with the factory Yamaha screws**



BORSI
PICKUPS



Three rounds to the left on the screw





BORSI
PICKUPS

Three rounds to the left on the screw

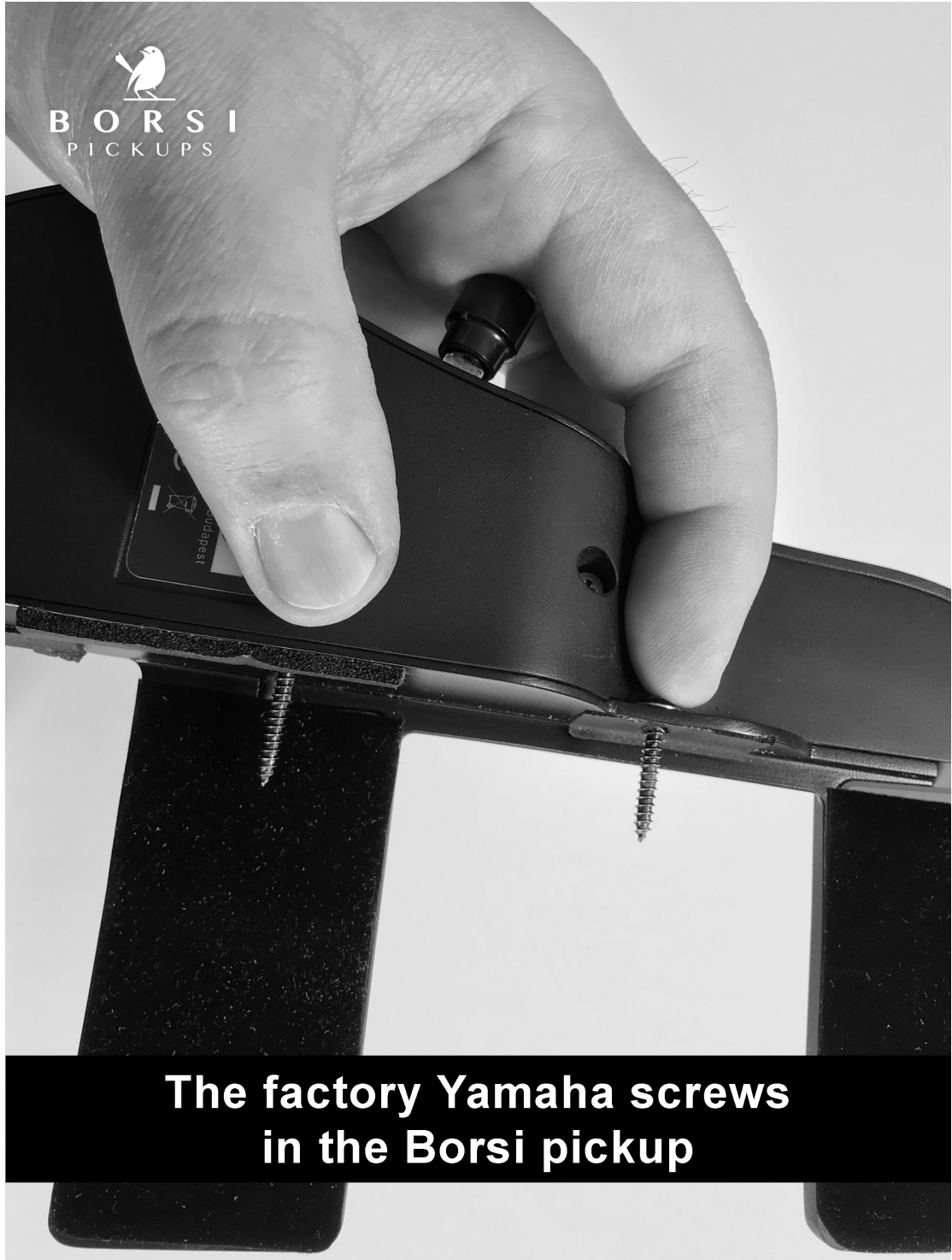

**Place one of the Yamaha factory screws
in the tube**



**The factory Yamaha screws
in the Borsi pickup**



BORSI
PICKUPS

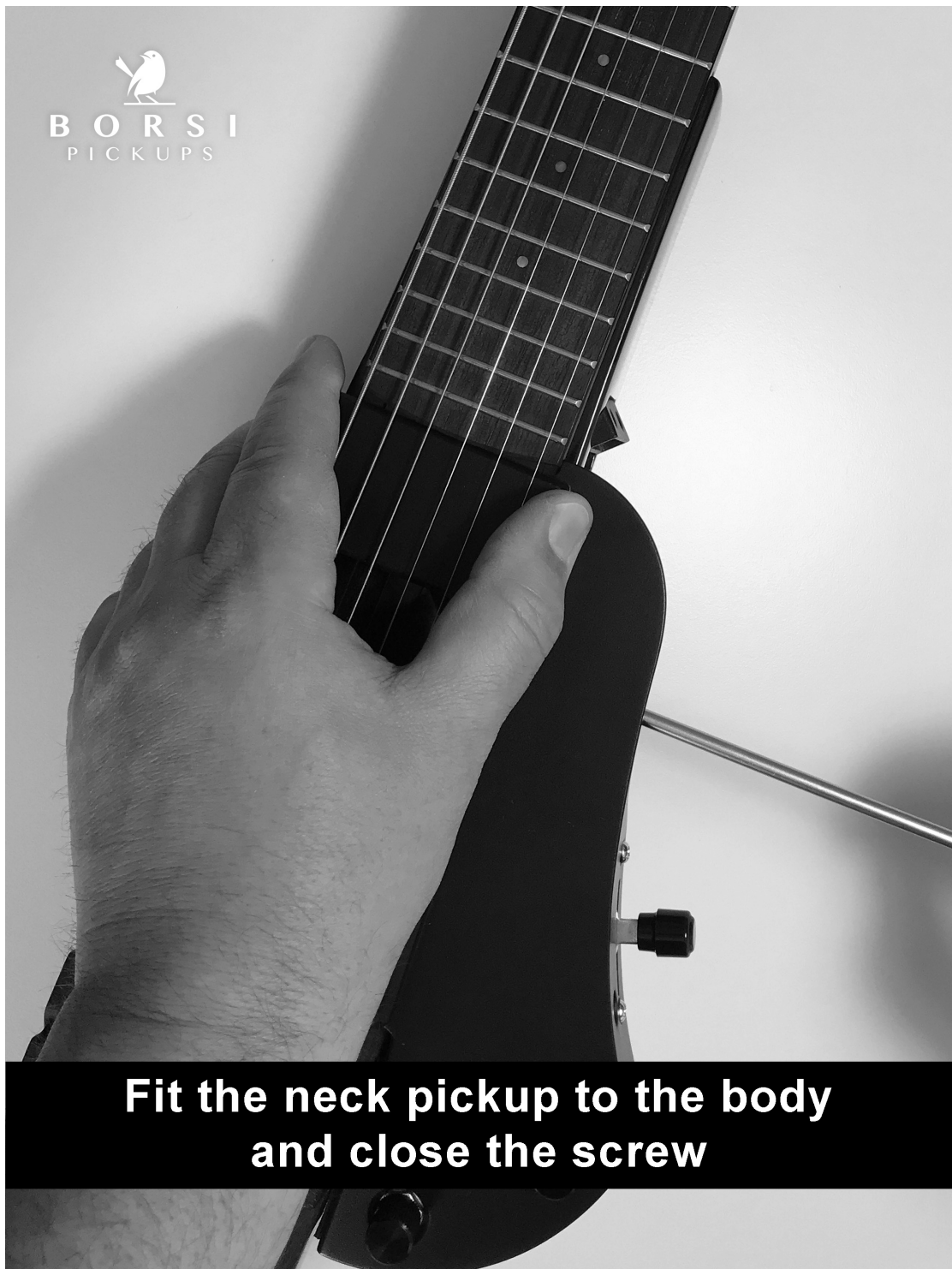

**Fit the neck pickup to the body
and close the screw**



Tighten the screw next to the bridge



BORSI
PICKUPS

**Check the free movement of
the string above the pickup**



BORSI
PICKUPS



**Check the free movement of
the string above the pickup**

BORSI
PICKUPS

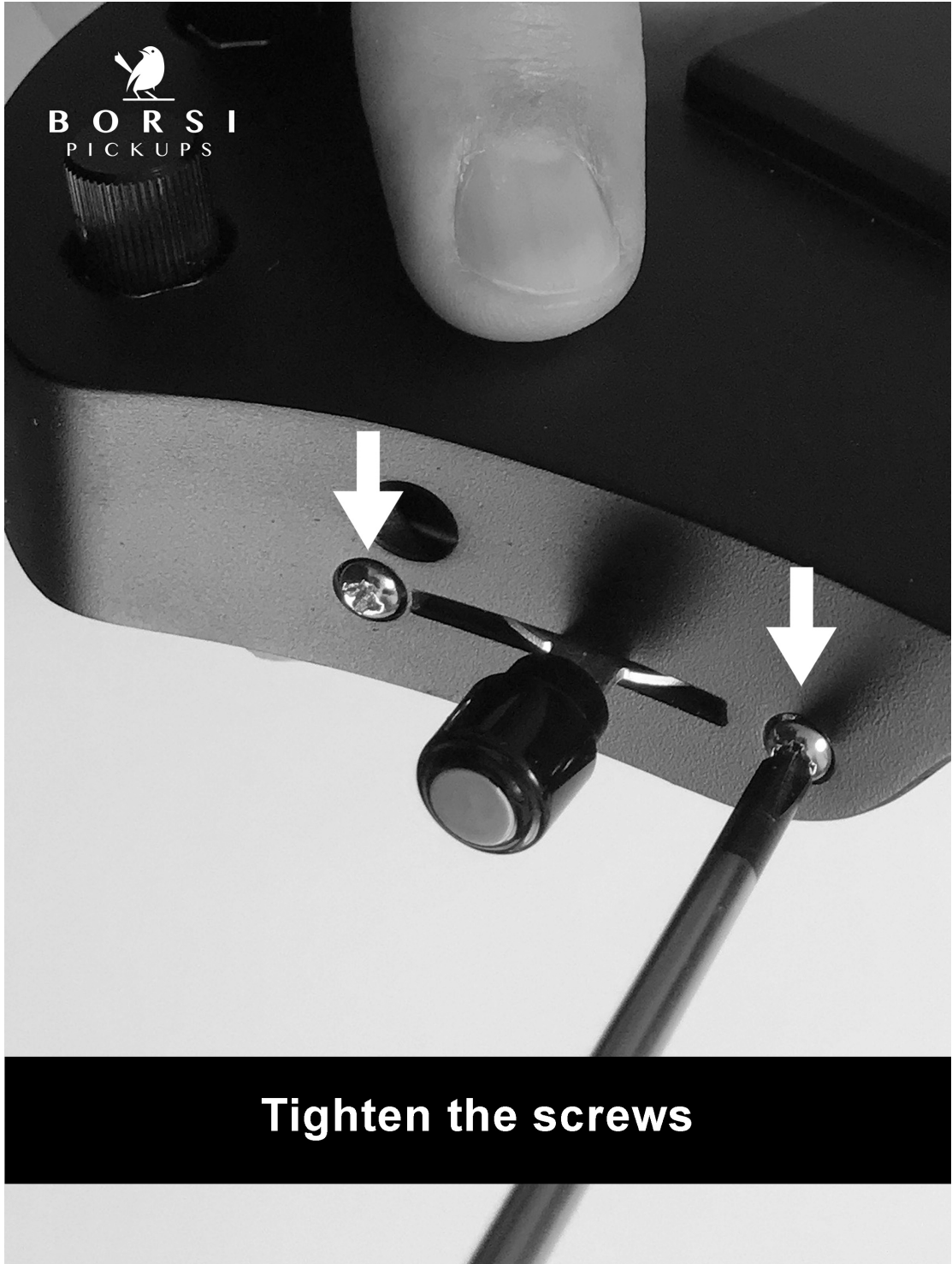

Tighten the screws

BORSI
PICKUPS



Ready...